

ELECTRICAL AND MECHANICAL NOTES

ELECTRICAL REQUIREMENTS

ALL EXISTING AND PROPOSED ELECTRICAL WORK SHALL BE THE RESPONSIBILITY OF THE ELECTRICAL SUBCONTRACTOR. THIS CONTRACTOR SHALL WIRE ALL EQUIPMENT REQUIRING POWER OR LOW VOLTAGE CONNECTION AS REQUIRED FOR PROPER FUNCTION. ALL WORK SHALL BE INCLUDED THAT IS SPECIFIED AS WELL AS ANY WORK REQUIRED TO PROPERLY COMPLETE THE PROJECT.

ANY ELECTRICAL FIXTURES REQUIRED BUT NOT SPECIFIED SHALL BE CARRIED AT A PURCHASE ALLOWANCE OF \$100 APIECE

ALL WIRING SHALL BE COPPER AND SIZED AS REQUIRED BY THE ELECTRICAL CODE.

HEATING & VENTILATING

PROVIDE 1/2" THICK FIBERGLASS INSULATION ON ALL PIPING. PLUMBING SUBCONTRACTOR TO MAKE WATER SUPPLY CONNECTIONS AND GAS CONNECTIONS ONLY.

PROVIDE ALL DUCTING AND RELATED WORK FOR BATHROOM FANS, KITCHEN EXHAUST, DRYER VENT, OVEN VENT, BROILER, ETC. AND PROPER CONNECTION OF SAME

THIS SUBCONTRACTOR SHALL SUBMIT DIAGRAMS DEPICTING ALL DUCT SIZING AND LOCATIONS. INCLUDED SHALL BE SPECIFICATIONS FOR EQUIPMENT PROPOSED. INSTALLATION MAY START ONLY UPON ARCHITECT'S APPROVAL

SEE SPECIFICATIONS FOR ADDITIONAL

PLUMBING REQUIREMENTS

ALL EXISTING AND PROPOSED PLUMBING WORK SHALL BE THE RESPONSIBILITY OF THE PLUMBING SUBCONTRACTOR. THIS CONTRACTOR SHALL PIPE ALL EQUIPMENT REQUIRING WATER, DRAINAGE OR GAS CONNECTION AS REQUIRED FOR PROPER FUNCTION. ALL WORK SHALL BE INCLUDED THAT IS SPECIFIED AS WELL AS ANY WORK REQUIRED TO PROPERLY COMPLETE THE PROJECT.

WATER PIPING SHALL BE 3/4" UNLESS OTHERWISE NOTED.

NO WATER PIPES (DOMESTIC OR HEATING) SHALL BE LOCATED IN EXTERIOR WALLS OR CEILINGS. ALL FIXTURES SHALL HAVE HOT & COLD SHUTOFF VALVES AT THE FIXTURE.

ALL HOT WATER LINES INCLUDING HEATER PIPES SHALL BE INSULATED WITH 3/8" WALL ARMAFLEX OR EQUAL

INSTALL GAS RANGES, WASHER/DRYER MACHINES AND HOT WATER HEATERS. PROVIDE GAS AND WATER TO GAS FURNACES.

INSTALL DISHWASHER, DISPOSAL, ICEMAKER LINES, AS REQUIRED

FINISH FIXTURES (SINK, SHOWER, TUB, VALVE SETS, TOILET) TO BE REIMBURSED BY OWNER. ALL OTHER ITEMS TO BE SUPPLIED BY PLUMBER.

OWNER TO SUPPLY MAJOR APPLIANCES (REFRIGERATOR, STOVE, OVEN, DISHWASHER, GARBAGE DISPOSAL)

MECHANICAL KEY

- R.A. INDICATES RETURN AIR
- S.A. INDICATES SUPPLY AIR
- Z1 INDICATES ZONE 1
- Z2 INDICATES ZONE 2
- [Symbol] SUPPLY OR RETURN DUCT IN WALL
- [Symbol] SUPPLY OR RETURN FLOOR REGISTER
- [Symbol] SUPPLY OR RETURN WALL REGISTER
- [Symbol] SUPPLY OR RETURN CEILING REGISTER
- [Symbol] INDICATES SUPPLY OR RETURN AIR
- [Symbol] BURNHAM RADIANT RADIATOR (INDICATES 4" SECTIONS)
- [Symbol] SUPPLY OR RETURN DUCT INDICATED IN CEILING ABOVE
- [Symbol] INDICATES NEW SECTION OF HOT WATER BASEBOARD (STERLING INDUSTRIES KP-50-2)

ELECTRICAL KEY

- [Symbol] 4" RECESSED LOW VOLTAGE FIXTURE
- [Symbol] SURFACE MOUNTED CEILING FIXTURE
- [Symbol] GARBAGE DISPOSAL (BATCH FEED)
- [Symbol] EXHAUST FAN (DUCTED TO EXTERIOR)
- [Symbol] 15 A DUPLEX RECEPTACLE GROUND FAULT WHERE REQ'D BY CODE
- [Symbol] SURFACE MOUNTED WALL FIXTURE
- [Symbol] THERMOSTAT
- [Symbol] INTERCOM (SEE SPECIFICATION)
- [Symbol] TRACK LIGHTING
- [Symbol] FLUORESCENT FIXTURE (SURF. TYP)
- [Symbol] 20W INSTANT START WITH LENS & ELECTRONIC BALLAST
- [Symbol] SMOKE DETECTOR (INTERCONNECTED TO SYSTEM)
- [Symbol] HEAT DETECTOR (INTERCONNECTED TO SYSTEM)
- [Symbol] MODULAR TELEPHONE JACK (TWO LINES)
- [Symbol] SWITCH
- [Symbol] S3 3 WAY SWITCH
- [Symbol] CBP FLUSH MOUNTED CIRCUIT BREAKER PANEL
- [Symbol] EMERGENCY EGRESS LIGHTING
- [Symbol] CATV CONNECTION TO PRE-WIRED CABLEVISION
- [Symbol] TPS TOP PLUG SWITCHED

SEE SPECIFICATIONS FOR ADDITIONAL

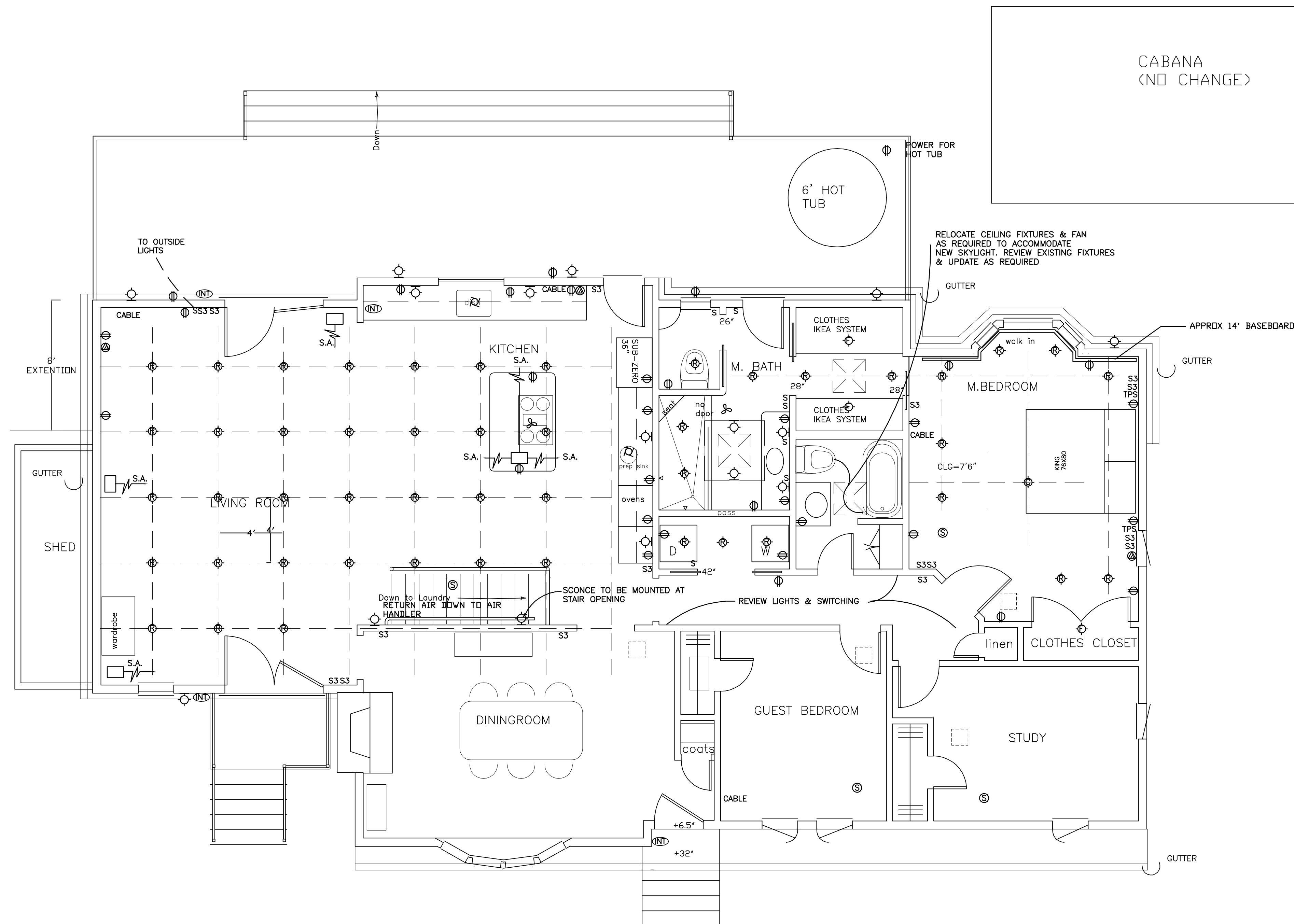

PROPOSED /MECHANICAL
FIRST FLOOR PLAN

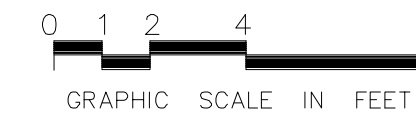

- [Symbol] INDICATES EXISTING SUPPLY AIR FOR AIR CONDITIONING
- [Symbol] INDICATES NEW SUPPLY AIR IN FLOOR FOR HEATING

KUNZ ASSOCIATES
38 GREENWICH PK
BOSTON, MA 02118
TEL: (617) 267-1482
FAX: (617) 425-0121

SUSAN & STEVEN SMEED
55 ESTEN ROAD
STOUGHTON, MA 02072